

Step 3: Evaluate Your Site: Soil

Soil Amendment

- Use compost when planting
- Small particles, usually less than 1/4"
- Mix compost with backfill soil
 - 30% most plants
 - 15% natives in disturbed soil
- Available in bags or bulk

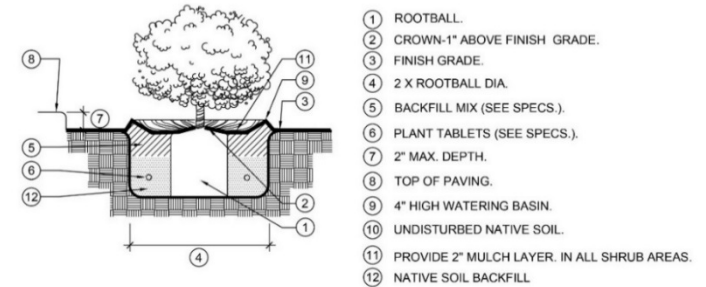

D SHRUB PLANTING DETAIL
NO SCALE

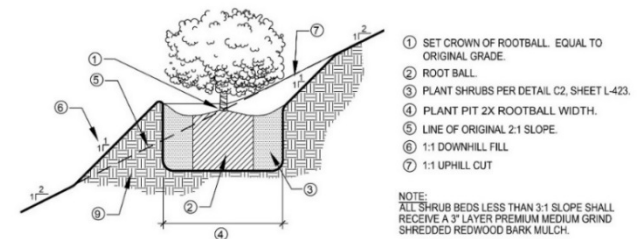

G SLOPE SHRUB PLANTING DETAIL
NO SCALE



Amending Soil with Compost